

INDUSTRIAL TEST SYSTEMS, INC.

COMBINED/TOTAL CHLORINE TEST

5 Tap **'SELECT Test'** at the top. Tap Chlorine, Free (DPD-1) CL. The iDip and app will both display Free Chlorine.

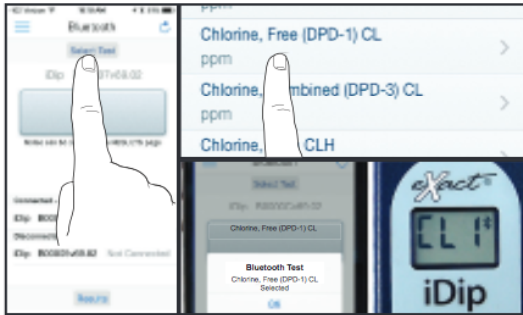

6 Remove one eXact® Strip Micro CL (DPD-1), 486637 and set in a dry, convenient place.



7 Rinse the cell 3 times with the water sample to be tested and **FILL** to the top to begin test.



8 Press **'ZERO/ON'** and the iDip® display reads 0_{PPM} indicating the meter is ready to test.



9 Press **'READ'** to initiate a 20 second countdown and simultaneously **DIP** the test strip by submerging all pads in the sample then use a gentle constant back and forth motion (2 strokes per second) until the timer displays "1". Remove and discard the strip. **READ** result displayed as Free Chlorine. **DO NOT** empty CELL, continue to step 10 to get result as Combined Chlorine.



10 Tap **'SELECT Test'** at the top. Tap Chlorine, Combined (DPD-3) CL. The iDip and app will both display Combined Chlorine.

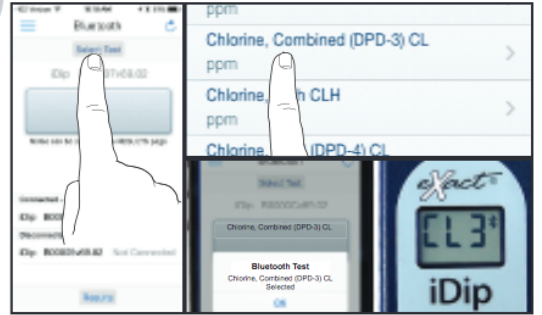

11 Press **'ZERO/ON'** and the iDip® display reads 0_{PPM} indicating the meter is ready to test.



12 Remove one eXact® Strip Micro CL (DPD-3) and set in a dry, convenient place.



13 Press **'READ'** to initiate a 20 second countdown and simultaneously **DIP** the test strip by submerging all pads in the sample then use a gentle constant back and forth motion (2 strokes per second) until the timer displays "1". Remove and discard the strip.



14 **READ** result displayed on the iDip® and in the app. To save your results and make available for emailing, continue on page 11 of your manual. For results as Total Chlorine, add the Free Chlorine and Combined Chlorine values together (e.g. 1.64 + 0.36 = 2.00 ppm). After testing is complete, rinse CELL immediately.

